

Crossfield Drive, Wigan, WN2 4GH
Offers Over £200,000

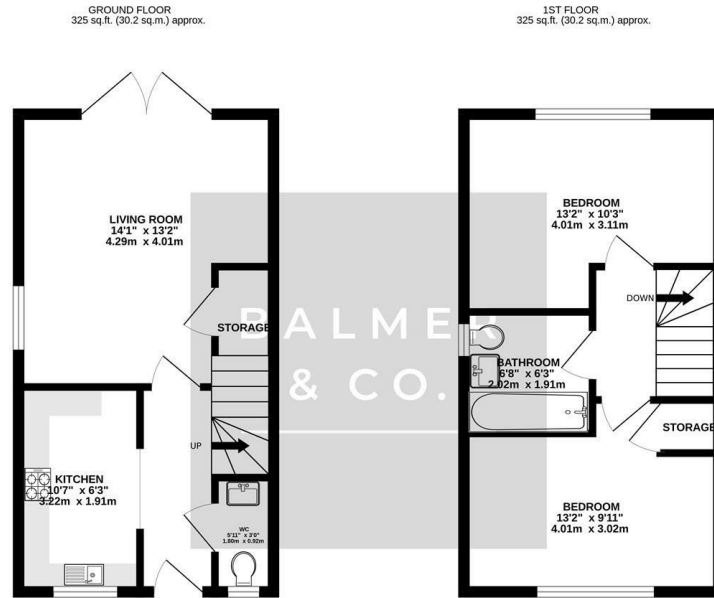

BALMER & CO in LEIGH are delighted to offer FOR SALE this fantastic two bedroom semi-detached house situated in a popular and well regarded residential location in Hindley Green. Offered with NO ONWARD CHAIN this property has been very well maintained by its current owner and is very nicely presented to the market. Comprising in brief of entrance hallway, modern fitted kitchen with integrated appliances, large open plan living/dining room with French doors leading to the rear garden, with a W.C. completing the ground floor. To the first floor is a large master bedroom, second large double bedroom, with a three piece family bathroom completing the accommodation on offer. Externally the property has a driveway, garden and visitors spot to the front, whilst to the rear there is a fully enclosed, South facing garden with lawn and patio areas. Early viewings highly recommended, all enquiries welcome.

Floor Plan



TOTAL FLOOR AREA: 649 sq.ft. (60.3 sq.m.) approx.
While every attempt has been made to ensure the accuracy of the floorplans contained here, measurements of doors, windows, rooms and any other items are approximate and no responsibility is taken for any error, omission or misstatement. This plan is for guidance purposes only and should be used in conjunction with any prospective purchase. The services, systems and appliances shown have not been tested and no guarantee as to their operability or efficiency can be given.
Made with Metrepx ©2026

Area Map

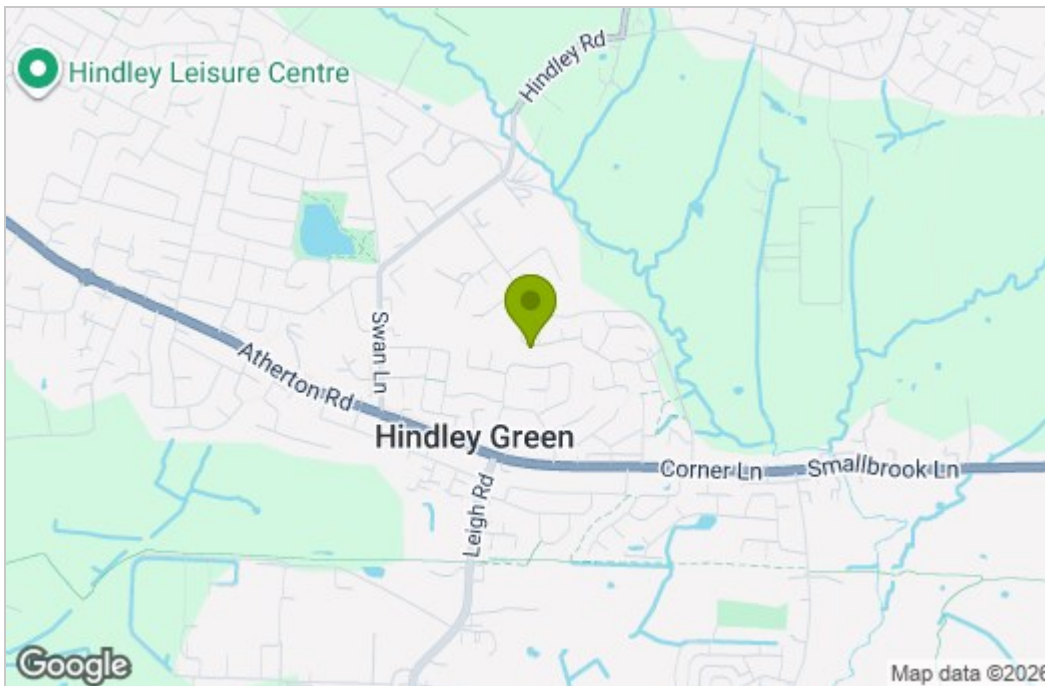

Energy Efficiency Graph

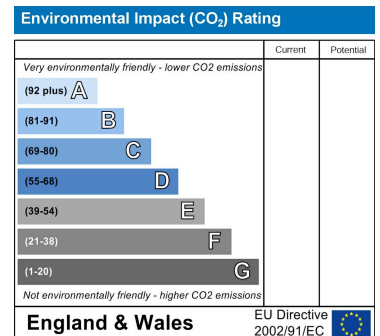
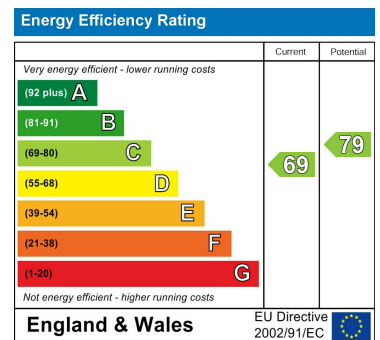

These particulars, whilst believed to be accurate are set out as a general outline only for guidance and do not constitute any part of an offer or contract. Intending purchasers should not rely on them as statements of representation of fact, but must satisfy themselves by inspection or otherwise as to their accuracy. No person in this firm's employment has the authority to make or give any representation or warranty in respect of the property.